

BLADEN

WEBSTER COUNTY
NEBRASKA

POPULATION 291 (2000 CENSUS)
1996

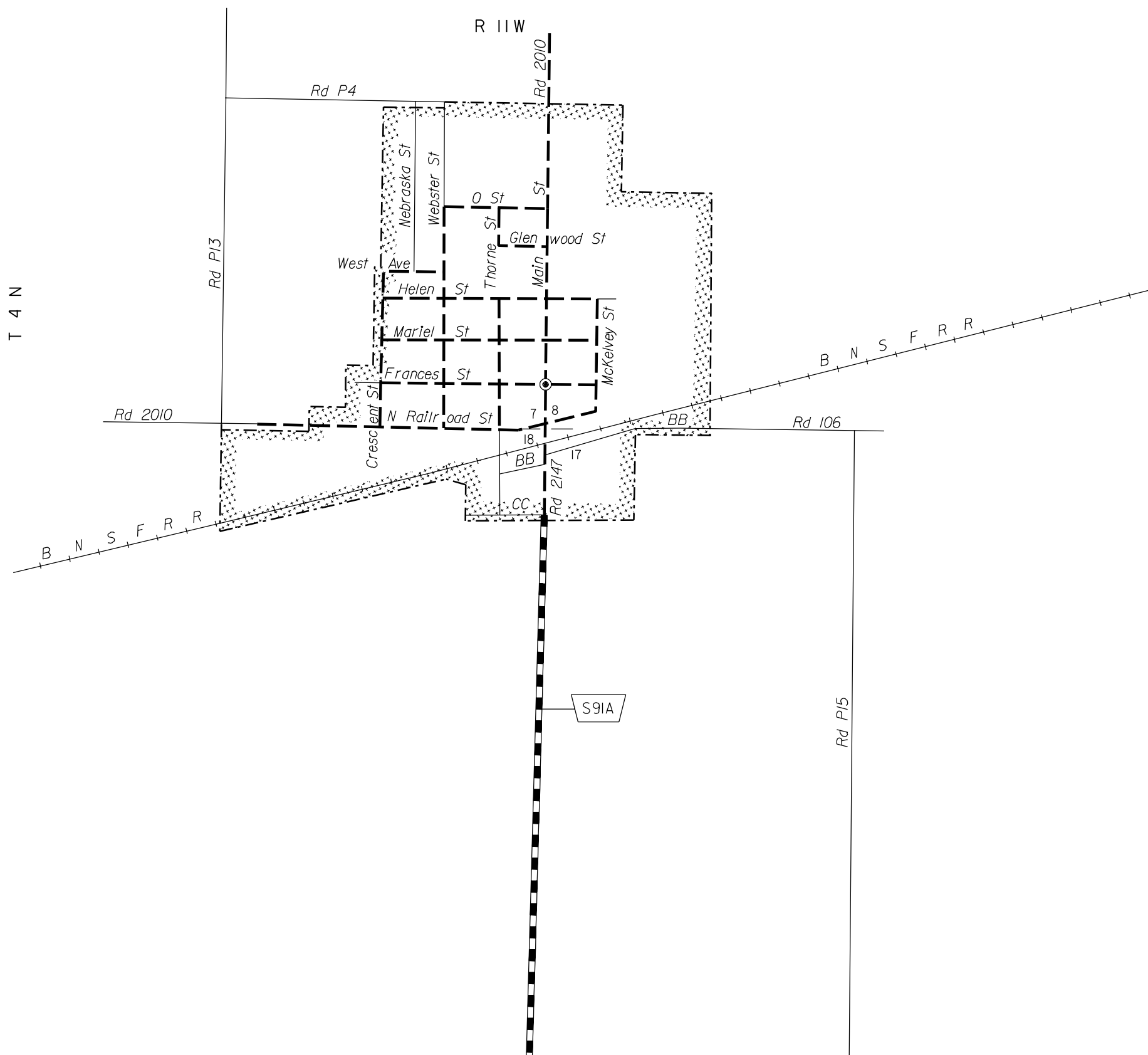
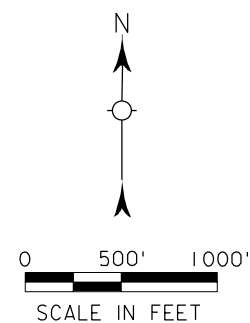

STATE HIGHWAYS

- Gravel or Crushed Rock
- Asphalt/Bituminous Surface
- Concrete/Brick Surface

CITY STREETS AND COUNTY ROADS

- Primitive or Unimproved
- Gravel or Crushed Rock
- Non-Rigid Pavement (BM or ACSC)
- Rigid Pavement (PCC, ACSC or Brick)

Interstate Numbered Routes

U.S. Numbered Routes

State Numbered Routes

State Numbered Spurs

State Numbered Links

In 116 Inventoried Numbered Routes

Ma 1480 Major Collector Routes

Mi 7100 Minor Collector Routes

Ur 5092 Urban Routes

RD 767 911 NAMED/Numbered Routes

City Center

Corporate Limits

CORPORATE LIMITS AS OF 1999
STATE HIGHWAYS CORRECTED TO 1997

Rev 10-99